

# PUBLIC PERFORMANCE REVIEW

Goal 3.1 – Combating Climate Change

*November 18, 2021*

The background of the slide features a large, faint, dark blue seal of the State of Washington. The seal is circular and contains a portrait of George Washington. The text "THE STATE OF WASHINGTON" is arched across the top, and "1889" is at the bottom.

# WELCOME

PRESENTED BY:

- CHRISTY BEZANSON, DIRECTOR, RESULTS WASHINGTON

# Zoom Overview

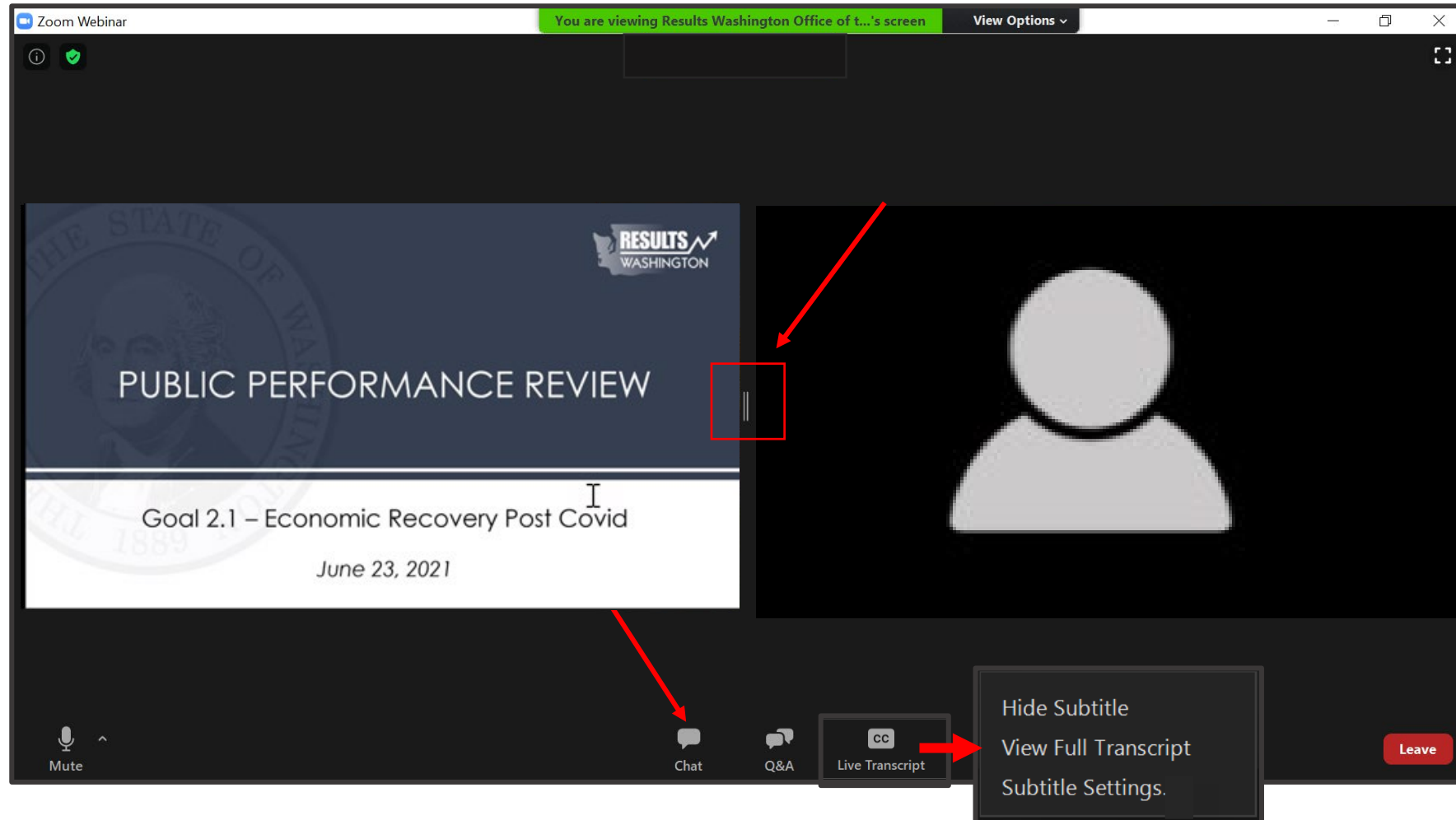

# Public Performance Review Purpose

---

The Public Performance Review is our monthly meeting with the Governor, leaders, agency experts, and community members designed to:

- Focus on a cross-agency project tied to the Governor's priorities
- Hear from those impacted by the project – those with lived experiences and those who are customers and process partners in the community
- Engage in discussions and problem-solving on these complex topics

# Public Performance Review Project Selection

---



1. Held agency meetings to finalize improvement project recommendations for each Goal area topic.
2. Agencies self-selected their participation and designated subject matter experts (SMEs) for each improvement project based on RASCI criteria.
3. Facilitated agency meetings to finalize improvement project focus for each Goal area.
4. RW and agency SMEs have been actively working to define project scope and develop charters and project plans.

# Project Focus

---

In partnership with the State Efficiency and Environmental Performance Office (SEEP), integrate enterprise-level and agency business processes and operations to align with emissions reduction goals

# Project Team

---

## ***Sponsoring Agencies***

Department of Commerce, Department of Ecology, Department of Enterprise Services

## ***Support, Consulted, and Informed Agencies***

- Department of Health
- Office of Financial Management
- Puget Sound Partnership
- Washington State Department of Transportation

# Opening Remarks

The background of the slide features a large, faint, circular seal of the State of Washington. The seal contains a portrait of George Washington, with the text "THE STATE OF WASHINGTON" around the top and "1889" at the bottom.

# PROJECT INTRODUCTION

## PRESENTED BY:

- LAURA WATSON, DIRECTOR, DEPARTMENT OF ECOLOGY

The background of the slide features a large, faint, dark blue seal of the State of Washington. The seal is circular and contains a portrait of George Washington. The words "THE STATE OF WASHINGTON" are inscribed around the top half of the circle, and "1889" is at the bottom.

## OPPORTUNITY AND PROJECT OVERVIEW

PRESENTED BY (IN ORDER OF  
PRESENTATION):

- STACEY WATERMAN-HOEY, GHG  
EMISSIONS ANALYST, DEPARTMENT OF  
ECOLOGY
- HANNA WATERSTRAT, SEEP DIRECTOR,  
DEPARTMENT OF COMMERCE



## Results WA

### State Agency Greenhouse Gas Emissions Reporting

Stacey Waterman-Hoey, GHG Emissions Analyst

Nov. 18, 2021

# Washington State GHG Emissions

\*Million Metric Tons of CO<sub>2</sub> equivalent

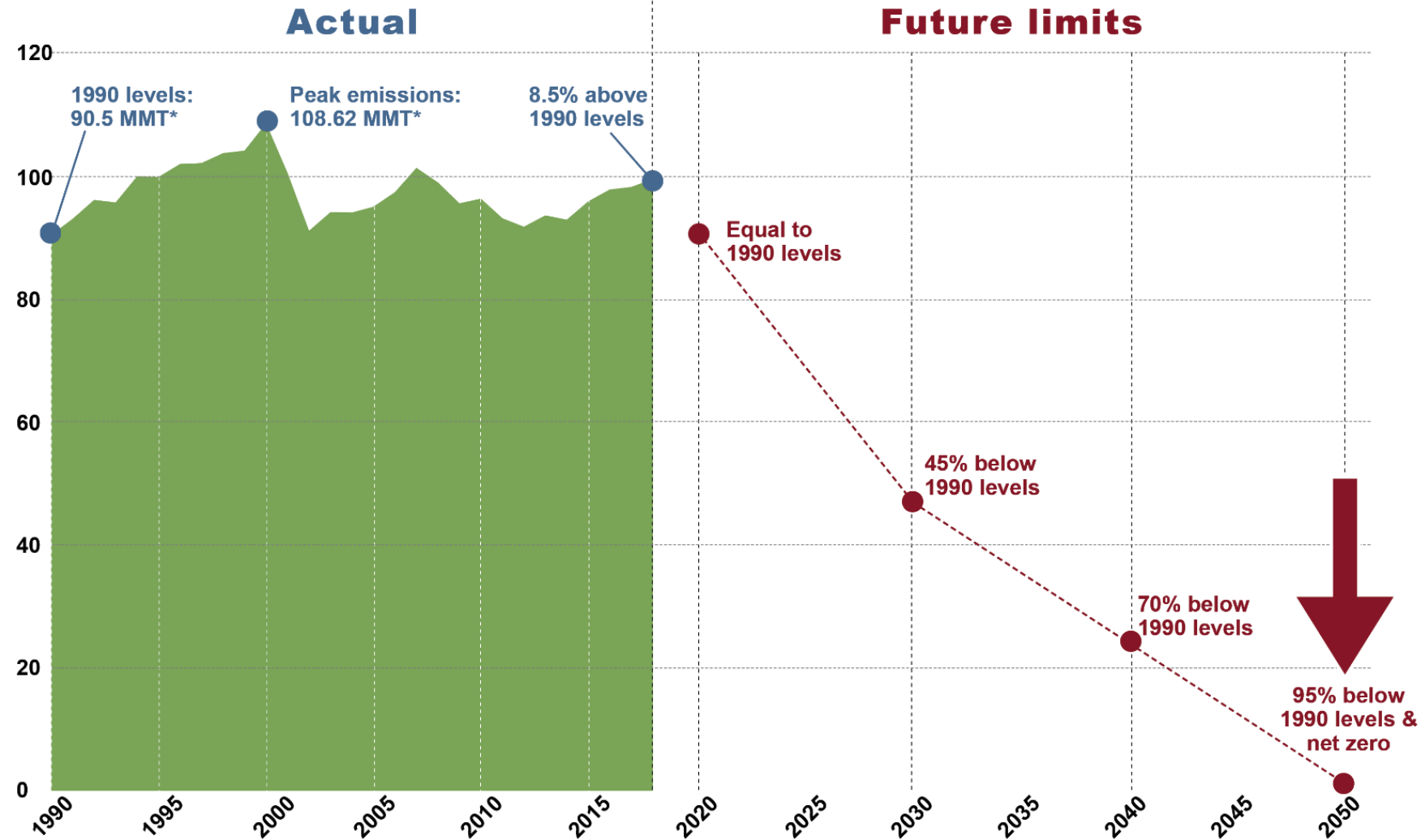

# Change in carbon intensity, 2005 forward

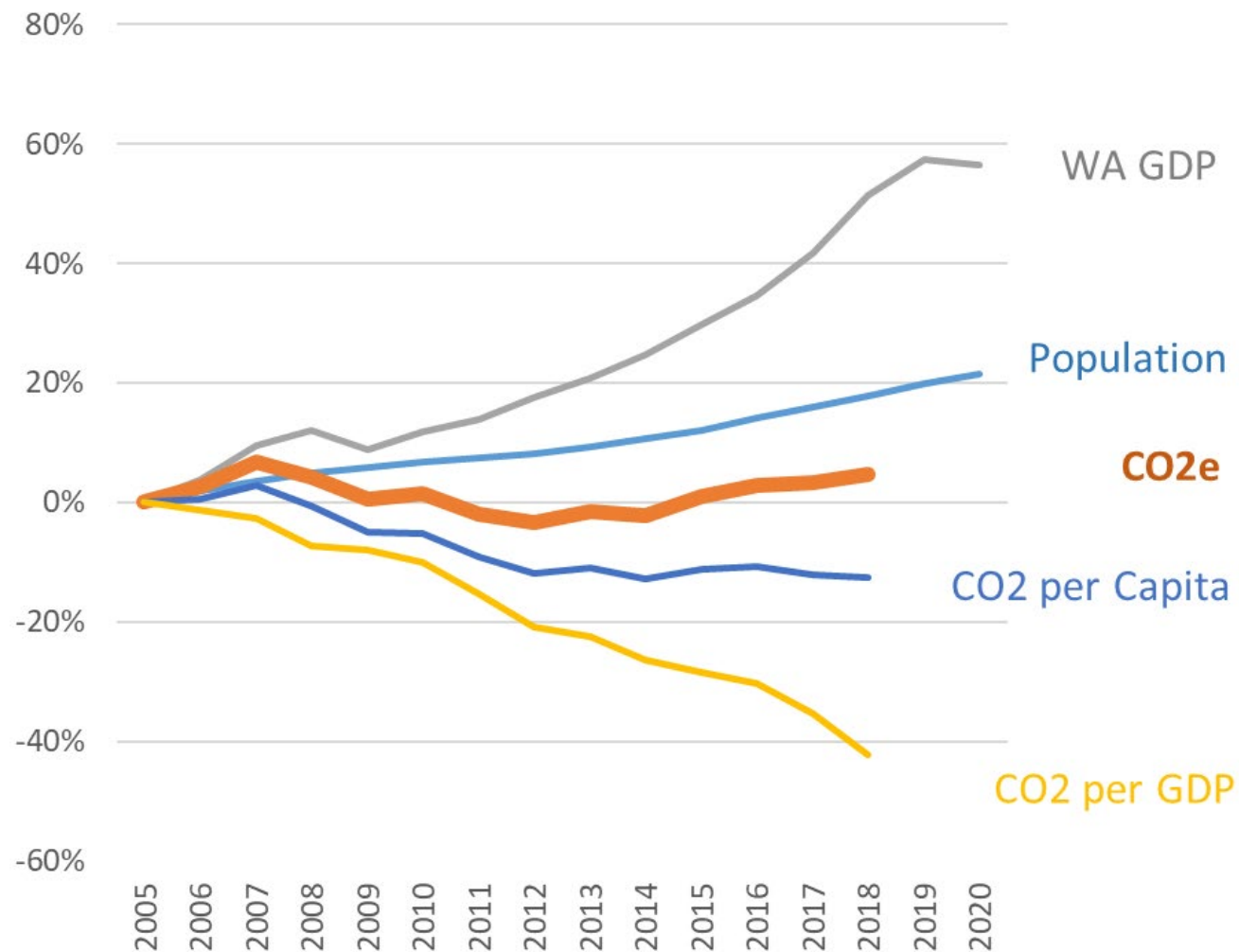

# Washington GHG Emission Limits:

Washington State		State Agencies Climate Leadership Act
2020	1990 level	15% below 2005 baseline
2030	45% below 1990	45% below 2005
2040	70% below 1990	75% below 2005
2050	95% below 1990, net zero	95% below 2005, net zero

# State Agency Historic Emissions & Future Limits

Buildings and Transport Emissions from 21 Largest Agencies

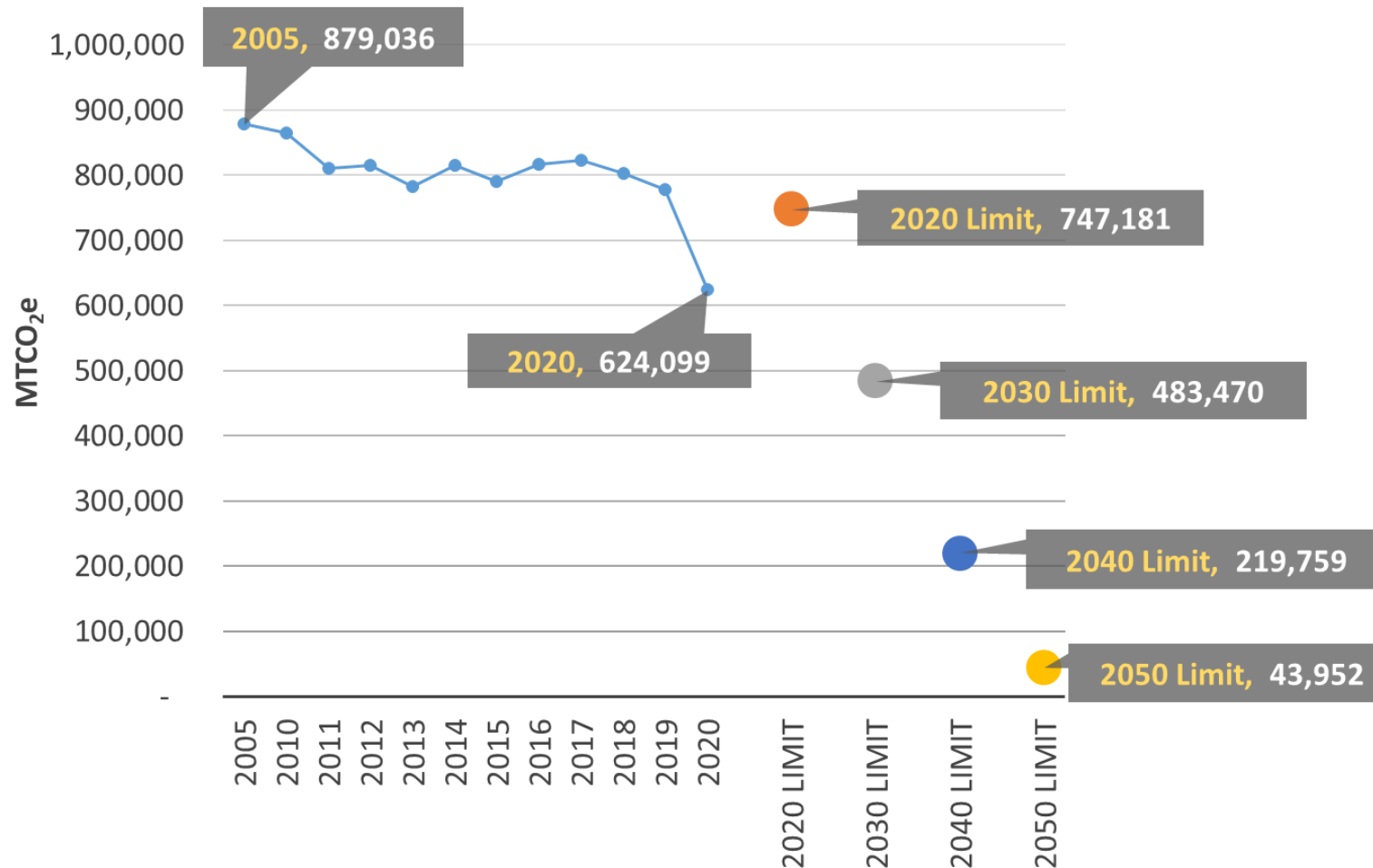

# State Agencies Progress Report

- ✓ 16 out of 21 agencies met their individual 2020 emission reduction goals
- ✓ Overall, state agencies reduced their emissions 16% below their 2020 limit

Was it the pandemic? Not entirely...

- ✓ 12 of these agencies met the 2020 goals in 2019
- ✓ Across all agencies, emissions were 4% above the limit in 2019

# Largest state agency emitters

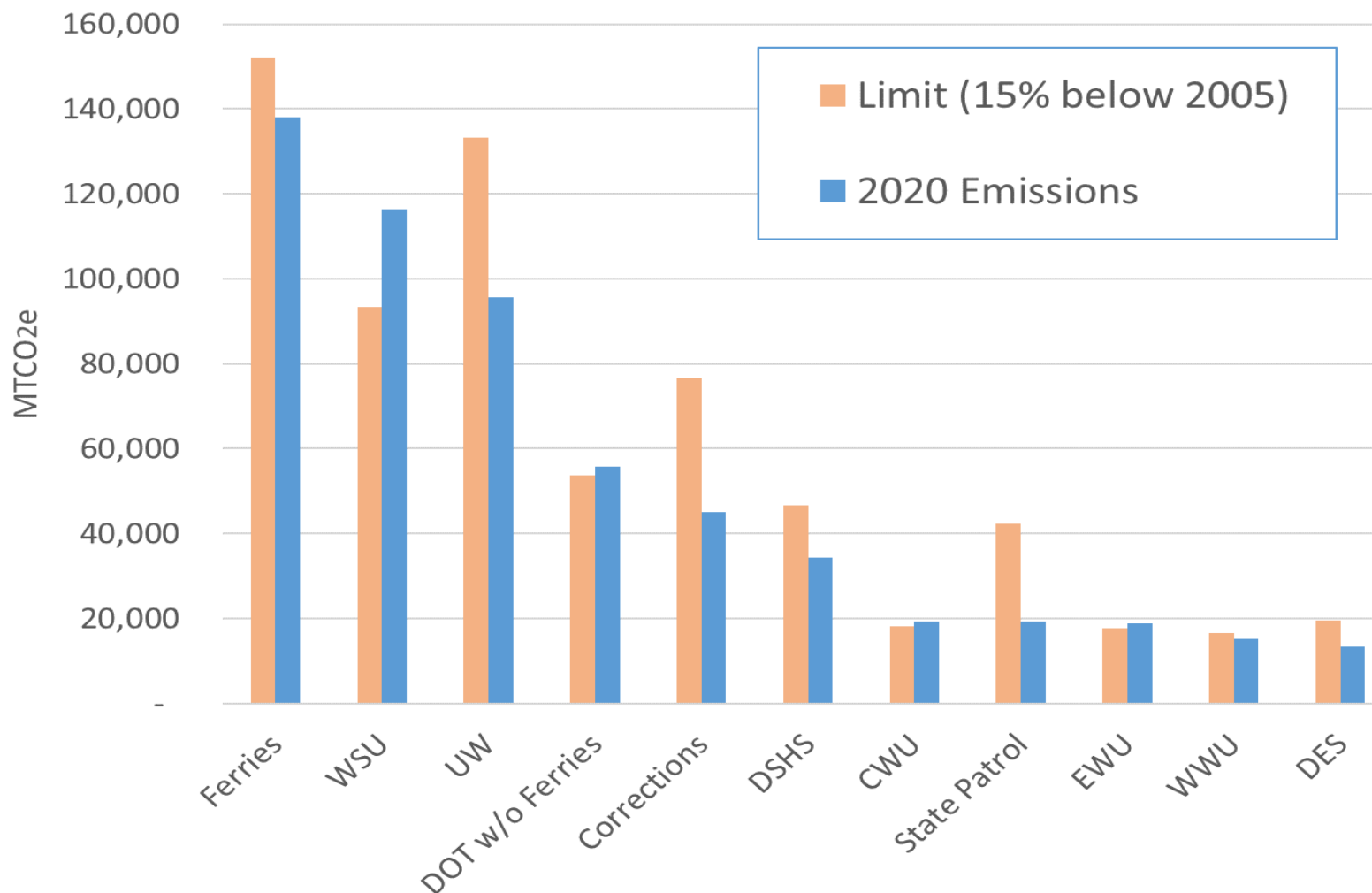

# State Agency GHG Emissions by Sector

metric tons CO<sub>2</sub>e

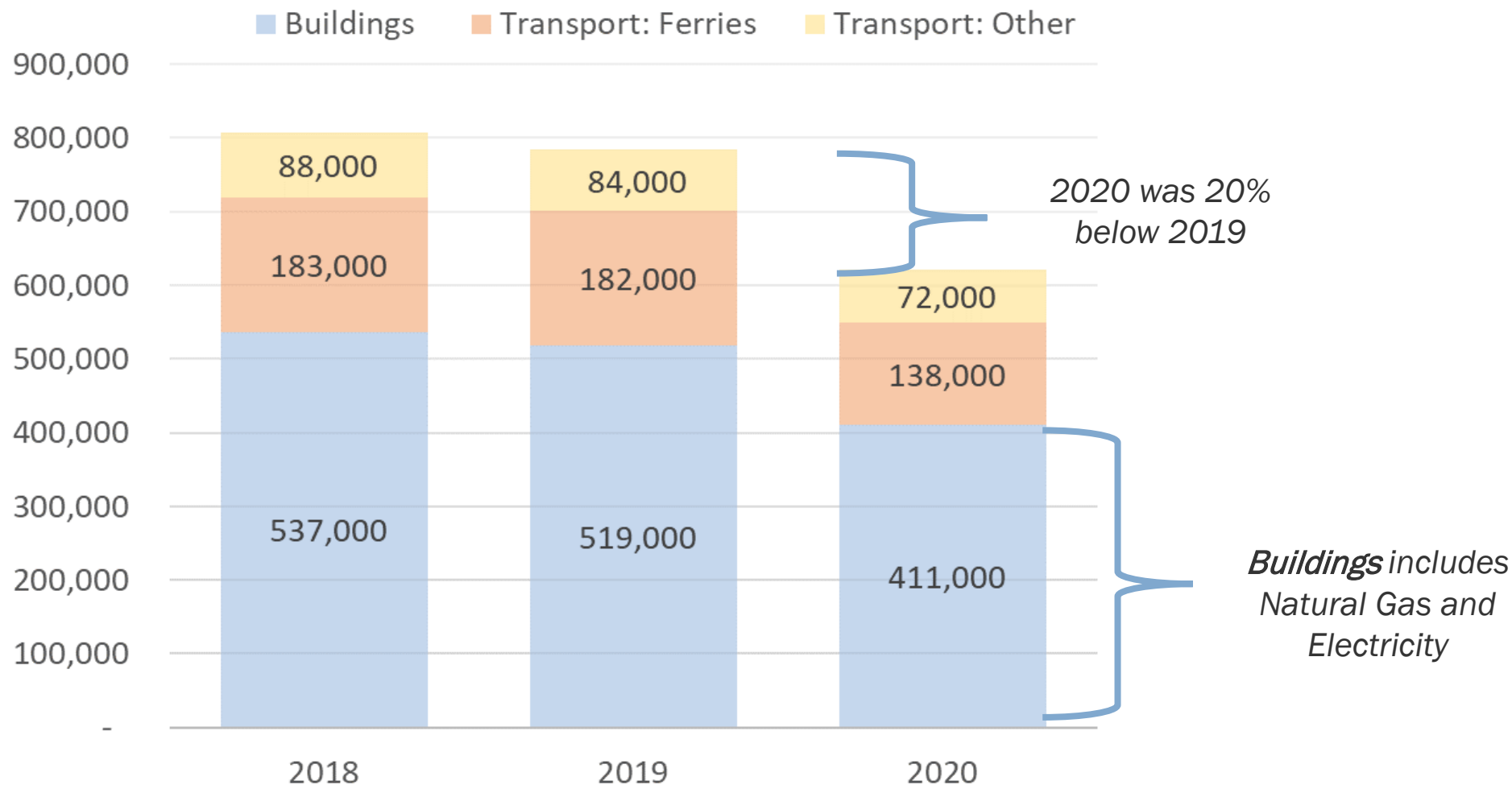



# Thank you



Stacey Waterman-Hoey

Air Quality Program, Climate Policy Section

[swat461@ecy.wa.gov](mailto:swat461@ecy.wa.gov)

# We strengthen communities

---

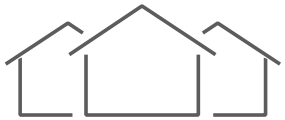

**HOUSING  
HOMELESSNESS**



**INFRASTRUCTURE**



**BUSINESS  
ASSISTANCE**



**ENERGY**

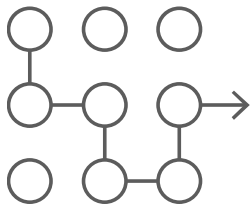

**PLANNING**

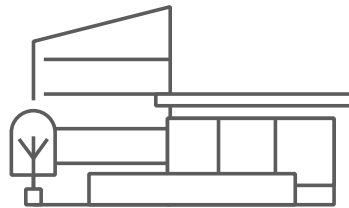

**COMMUNITY FACILITIES**



**CRIME VICTIMS &  
PUBLIC SAFETY**



**COMMUNITY  
SERVICES**

# SEEP basics

---

## Executive Order 20-01:

- Reduce greenhouse gas emissions
- Zero energy buildings
- Electric vehicles
- Sustainable purchasing

## Collaborative framework:

- Executive Governing Council
- Subject-specific working groups
- Expert support

### State Agency Partners

- |  |  |
|--|--|
| ○ Department of Agriculture                          | ○ Department of Natural Resources          |
| ○ Department of Children, Youth, and Family Services | ○ Department of Social and Health Services |
| ○ Department of Commerce                             | ○ Department of Transportation             |
| ○ Department of Corrections                          | ○ Department of Veterans Affairs           |
| ○ Department of Ecology                              | ○ Liquor and Cannabis Board                |
| ○ Department of Enterprise Services                  | ○ Office of Financial Management           |
| ○ Department of Health                               | ○ Washington State Patrol                  |
| ○ Department of Labor and Industries                 |  |

# Working together to reduce GHG emissions

---

Recent changes to RCW 70A.45.050 will link greenhouse gas emission reporting to agency decision-making.

- **The old way:**

- Report greenhouse gas emission emissions data.
- Identify actions taken in the previous two years to reduce emissions.

- **The new way:**

- Report greenhouse gas emission data.
- Identify strategies to meet emissions limits.
- Make recommendations to the Legislature.
- Partner with Ecology to support strategy development and reporting efforts.



# Agency strategies to reduce GHG emissions

---

## Priority actions include:

- Fleet electrification: Add EV charging to state facilities
- Building decarbonization:
  - All-electric energy systems/HVAC
  - Improve building energy efficiency
  - Zero energy buildings with on-site solar (new construction)
  - Lower carbon building materials
- Electrify district heating systems
- WSDOT: Ferry electrification



# Existing policies and requirements

---

- State agency greenhouse gas reporting (RCW 70A.45.050)
- Clean Buildings (RCW 19.27A.200)
- Energy benchmarking (RCW 19.27A.190)
- Environmentally preferred purchasing
- Fleet electrification (Executive Order 21-04)
- Low carbon construction (Buy Clean and Buy Fair)



# Role of SEEP

---

- Leadership and oversight
- Strategic interagency coordination
- Budget and funding requests
- Policy and program development
- Training, guidance and technical assistance





Washington State  
Department of  
**Commerce**

[www.commerce.wa.gov](http://www.commerce.wa.gov)



# Thank you!

Hanna Waterstrat

SEEP DIRECTOR

[hanna.waterstrat@commerce.wa.gov](mailto:hanna.waterstrat@commerce.wa.gov)

360-764-0015

A large, faint, light blue watermark of the Seal of the State of Washington is visible in the background. It features a portrait of George Washington, the text "THE STATE OF WASHINGTON", and the year "1889".

# Governor Q&A

The seal of the State of Washington is visible in the background on the left side of the slide. It features a circular design with a portrait of George Washington in the center. The words "THE STATE OF WASHINGTON" are written around the top half of the circle, and "1889" is at the bottom. The seal is rendered in a dark blue, semi-transparent style.

## AGENCY PROJECT

PRESENTED BY (IN ORDER OF PRESENTATION):

- BROOK BEELER, EASTERN REGION  
DIRECTOR, DEPARTMENT OF ECOLOGY
- SAM HUNN, EASTERN WASHINGTON SPILL  
RESPONSE UNIT SUPERVISOR, DEPARTMENT  
OF ECOLOGY



## Washington State's first Net-Zero building

Brook Beeler, Eastern Region Director  
Nov. 18, 2021

# Ecology below 2020 limit

and approaching 2030 limit

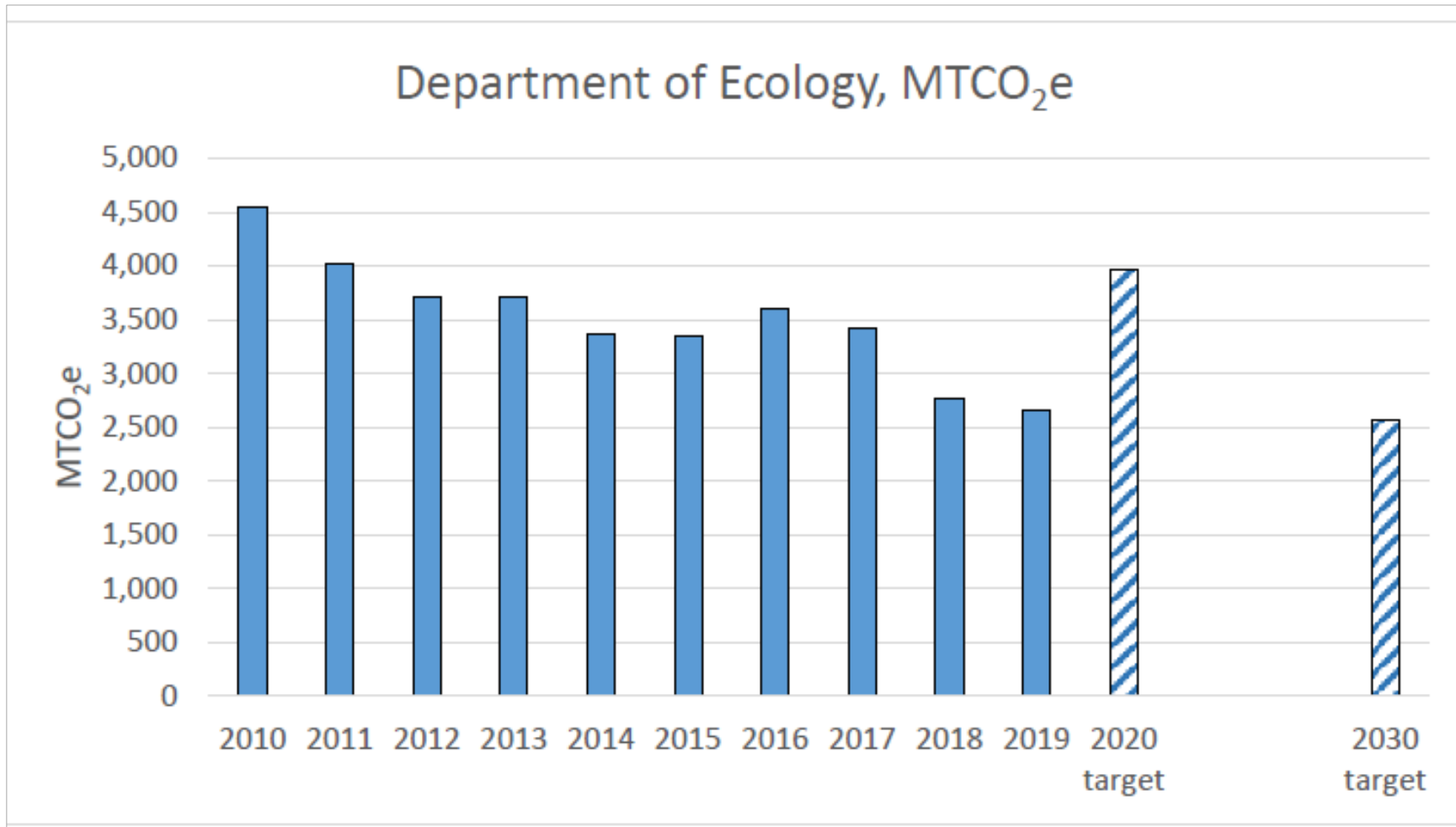

# All charged up!



# Investing in a cleaner future



# Ready to work for Washington



# And did we mention, Net Zero?



# A great, *green* place to work





## Improving spill response and performance at Ecology's new Net-Zero Eastern Region Annex

Sam Hunn, Spills Response Supervisor  
Nov. 18, 2021

# Eastern Washington spill response incidents by county

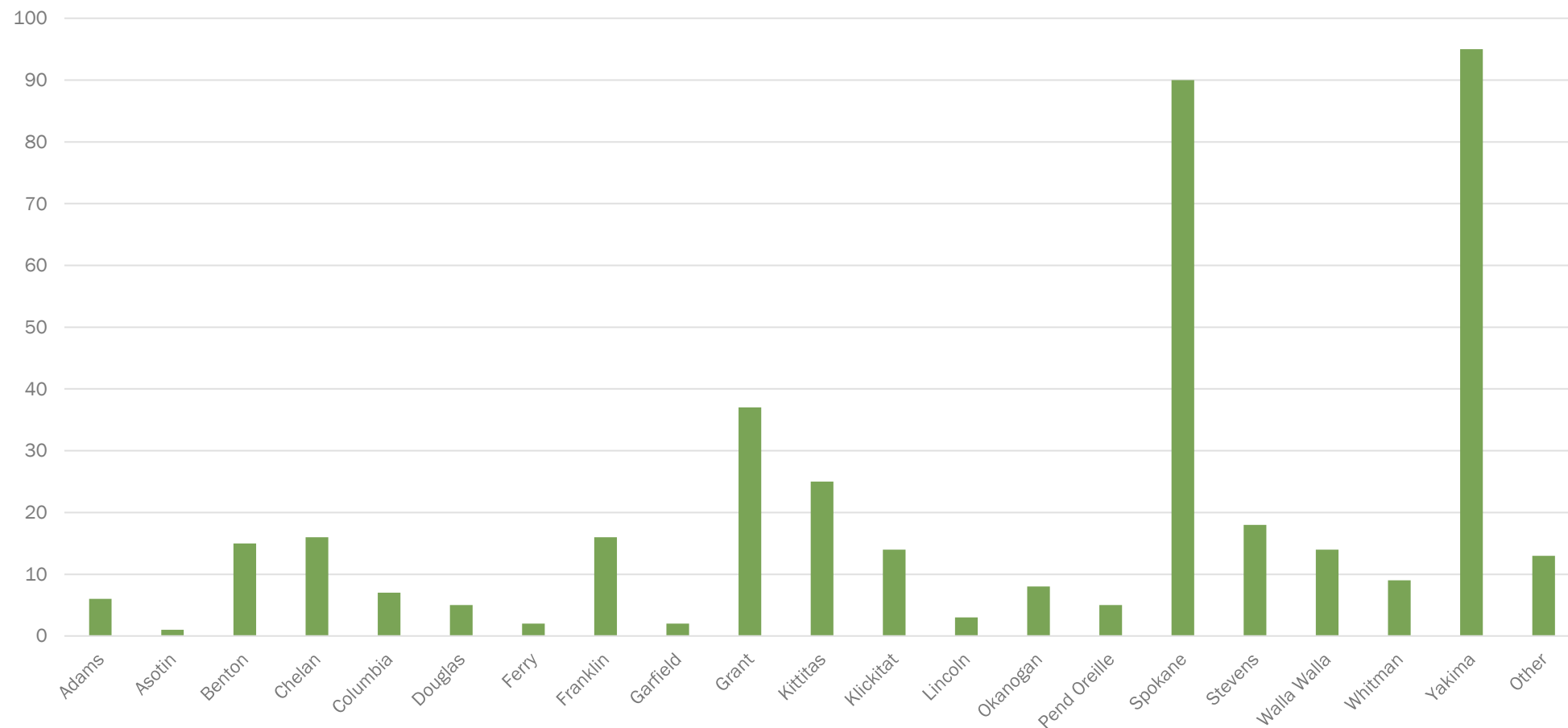

# Seconds matter...



# A place for everything ...and everything in its place



# On scene, on time





# Thank you

**Samuel Hunn**

Spill Prevention, Preparedness, and Response Program  
*[sam.hunn@ecy.wa.gov](mailto:sam.hunn@ecy.wa.gov)*

A large, faint, light blue watermark of the Seal of the State of Washington is visible in the background. It features a portrait of George Washington, the text "THE STATE OF WASHINGTON", and the year "1889".

# Governor Q&A



## AGENCY PROJECT

### PRESENTED BY:

- KELLY LERNER, CHIEF, LEASED FACILITIES & MAINTENANCE  
OPERATIONS, DEPARTMENT OF SOCIAL AND HEALTH SERVICES

# Charging Up For Electric Vehicles

A Look at DSHS' Electric Vehicle  
Charger Installations in 2021

November 18, 2021 Public Performance Review

**Kelly Lerner**

Chief of Leased Facilities and Maintenance Operations  
Facilities, Finance & Analytics Administration, DSHS



Clients of DSHS  
carry the biggest  
burdens of  
climate change



Mobile Community  
Service Office responds  
to Malden wildfire

Map reveals King County’s ‘heat islands’

Volunteers collected temperature data across King County on an extremely hot day last July. The data show that impacts of high temperatures are not felt evenly. Some areas were more than 20 degrees hotter than others. Tree cover reduces heat, while roads, pavement and rooftops intensify heat.

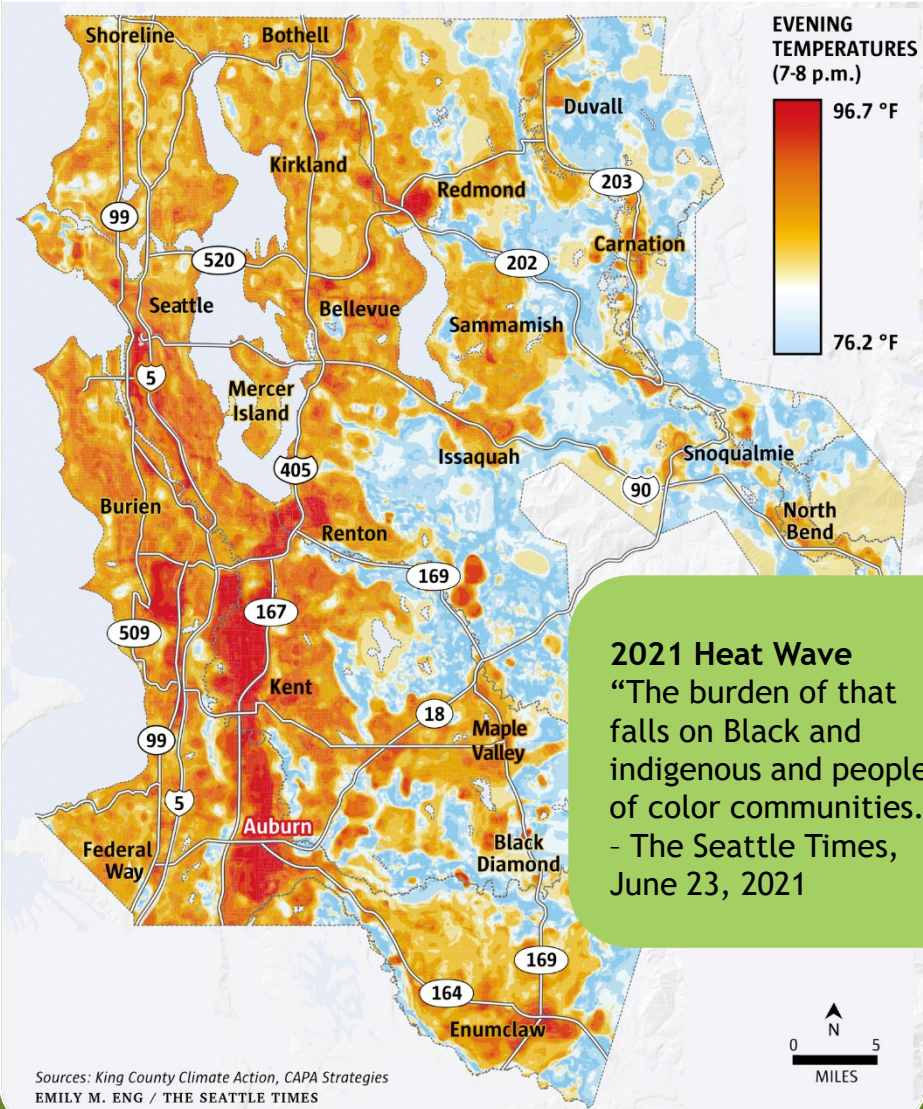

# DSHS Leased and Owned Facilities

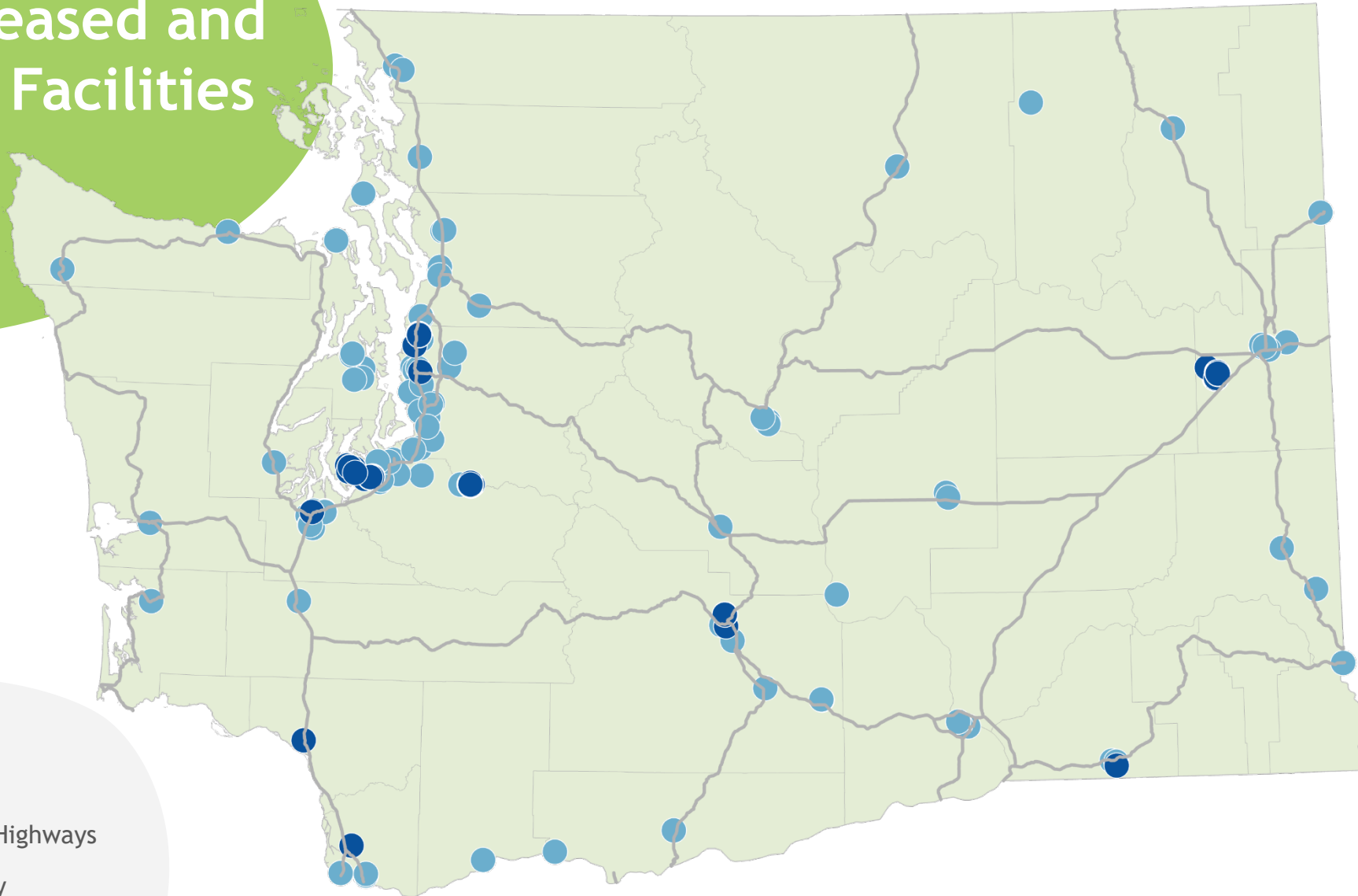

Interstates & Highways

Leased Facility

DSHS 24/7 Facility

# DSHS Leased and Owned Facilities

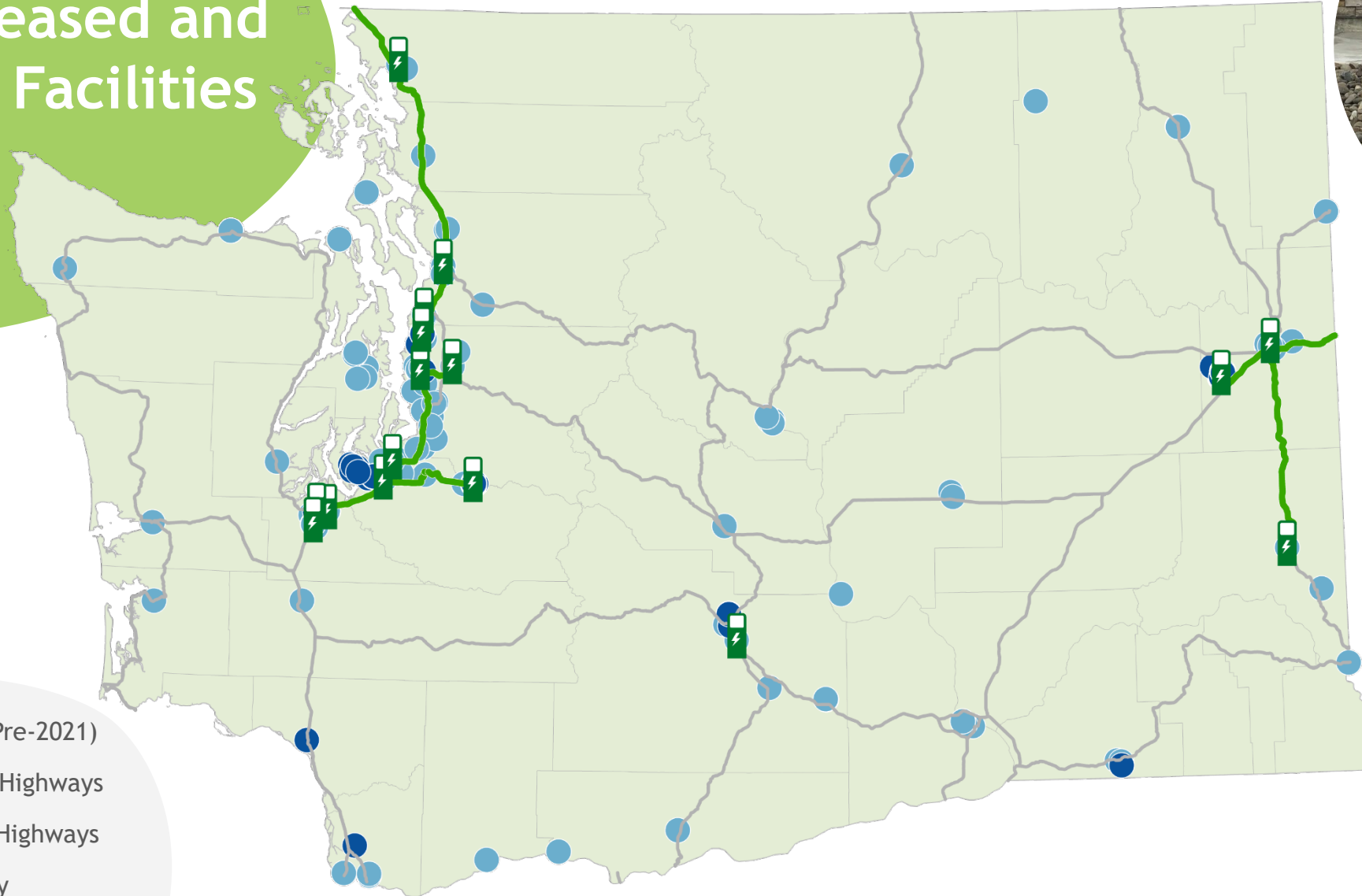

EV Charging (Pre-2021)



DSHS Electric Highways



Interstates & Highways



Leased Facility



DSHS 24/7 Facility



## By The Numbers

**2005:**  
27 EV Chargers  
installed at 24/7  
facilities

**2017:**  
13 EV Chargers  
installed at eight  
leased facilities

**Total:**  
40 EV Chargers  
with 72 charging  
heads throughout  
the state



# Boosting Our Infrastructure



Washington State  
Department of Social  
& Health Services

*Transforming lives*



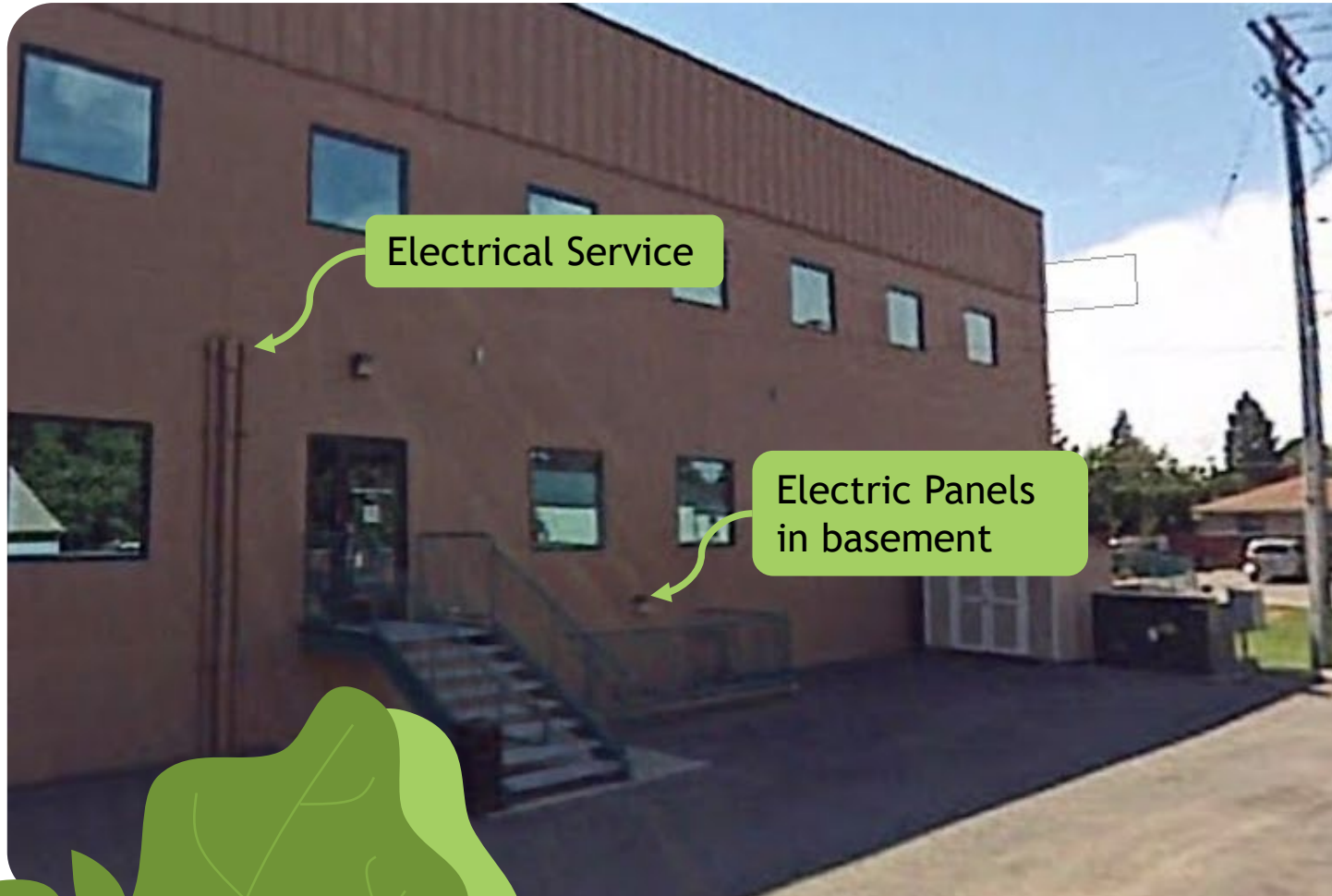

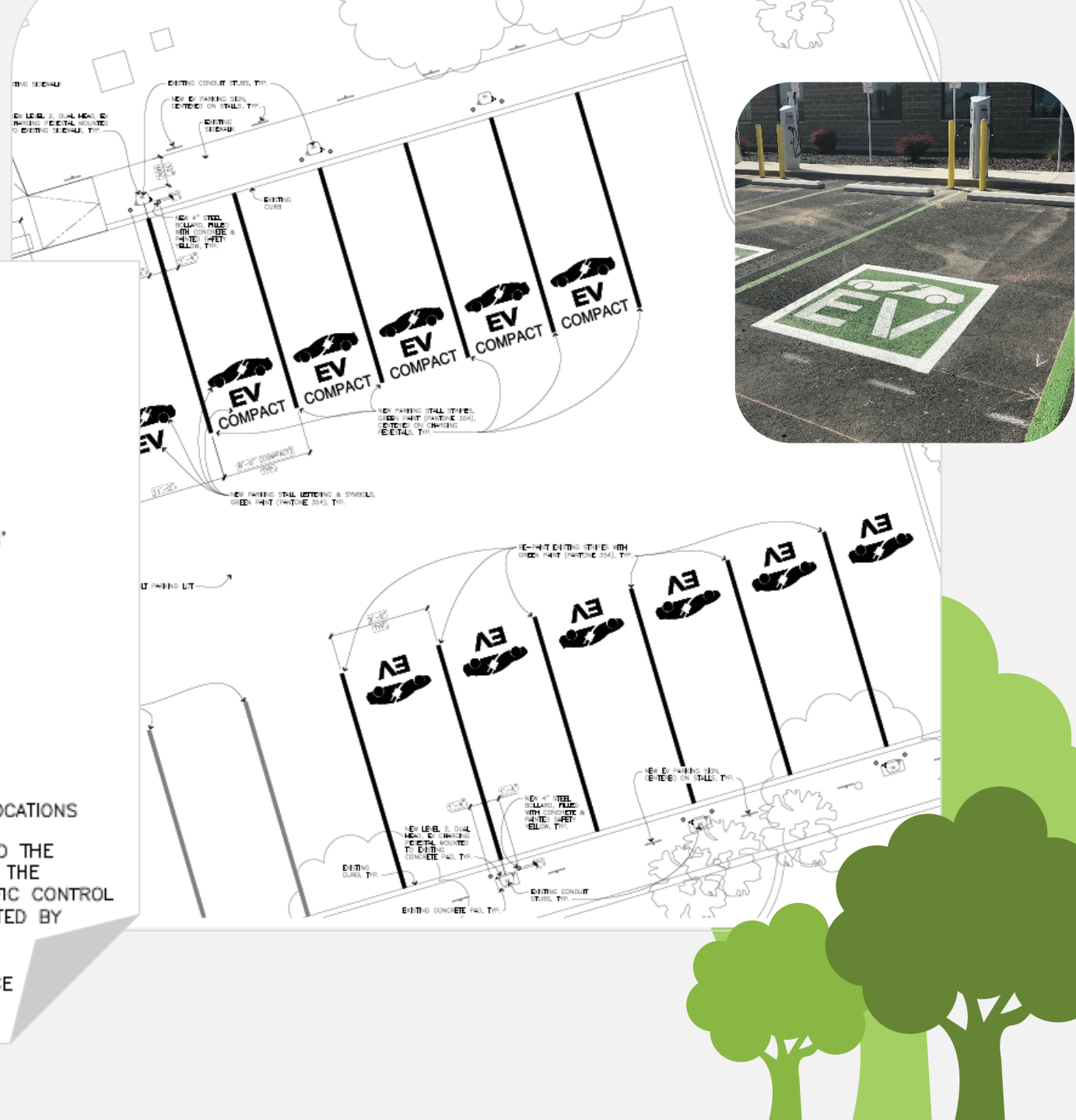
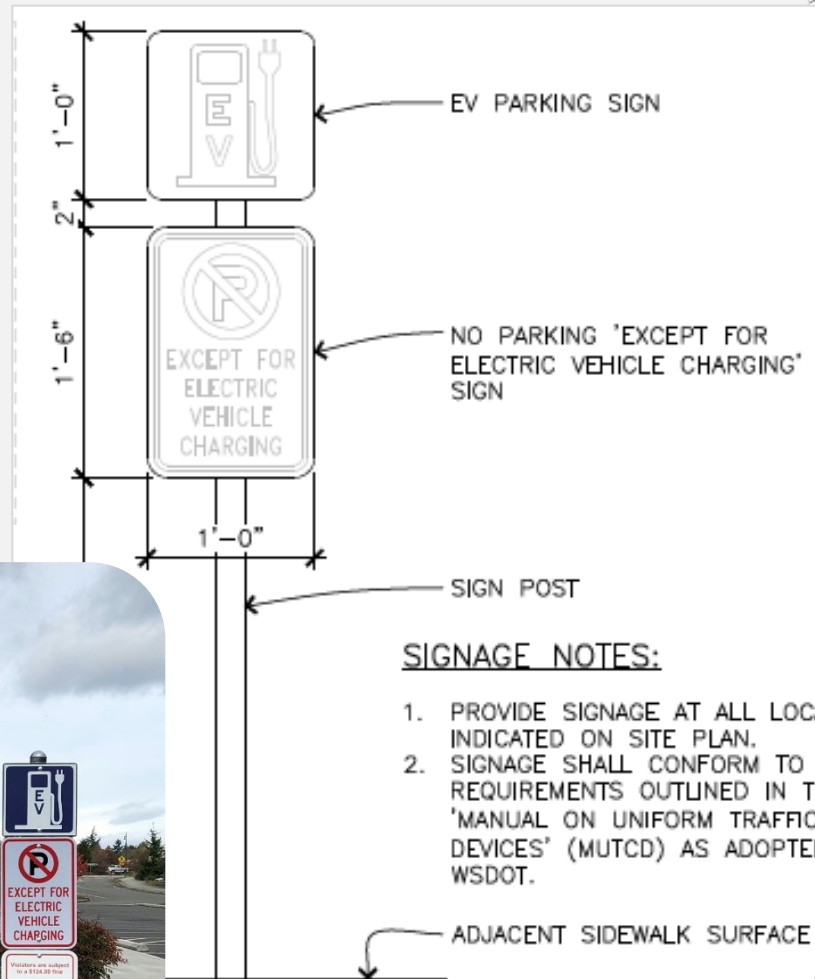

## Building Assessments



# Architectural Renderings

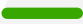

# EV Chargers Added in 2021

-  EV Charging Added in 2021
-  EV Charging (Pre-2021)
-  DSHS Electric Highways
-  Interstates & Highways
-  Leased Facility
-  DSHS 24/7 Facility

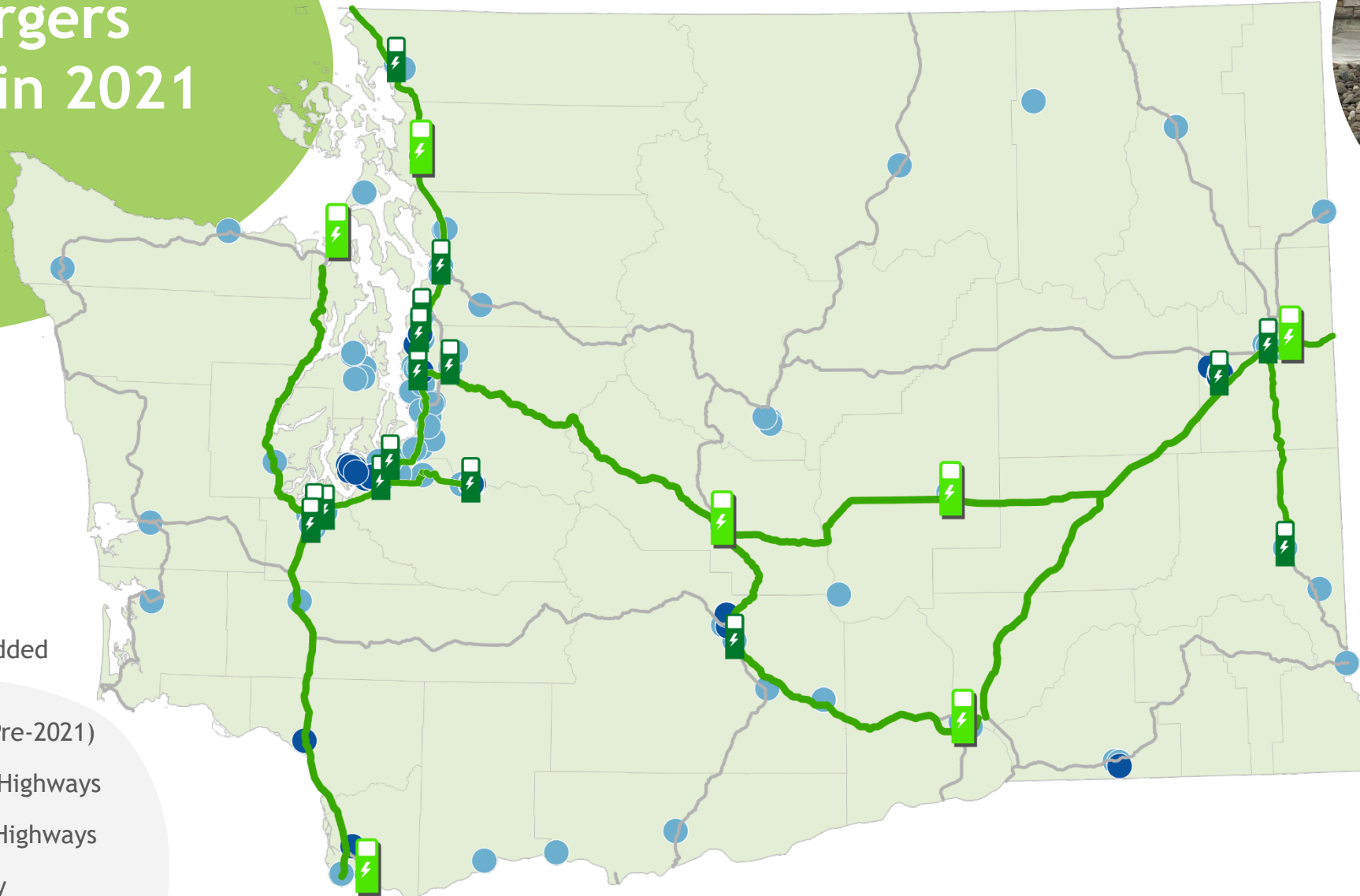

## By The Numbers

### Added in 2021:

21 level 2 Chargers  
with 42 charging  
heads at seven  
leased facilities

### DSHS Total:

61 EV Chargers  
with 114 charging  
heads throughout  
the state



We are just getting started toward our

# Electrified Carbon-Free & Equitable Future



*Washington State*  
Department of Social  
& Health Services

---

*Transforming lives*

---

# Governor Q&A

The background of the slide features a large, faint, circular seal of the State of Washington. It contains a portrait of George Washington and the text "THE STATE OF WASHINGTON" and "1889".

# CURRENT WORK AND FUTURE COMMITMENTS

PRESENTED BY (IN ORDER OF  
PRESENTATION):

- TARA C. SMITH, DIRECTOR, DEPARTMENT OF ENTERPRISE SERVICES
- RON MAJOR, RESOURCE CONSERVATION PROGRAM MANAGER, DEPARTMENT OF ENTERPRISE SERVICES
- HANNA WATERSTRAT, SEEP DIRECTOR, DEPARTMENT OF COMMERCE
- KENDRICK STEWART, DEPUTY DIRECTOR, DEPARTMENT OF COMMERCE

# DES'S CLIMATE CHANGE MITIGATION WORK

11 18 2021

Tara C. Smith, Director  
Enterprise Services

# DES COMBATS CLIMATE CHANGE

## **DES Facility Professional Services and Capitol Campus**



Nationally recognized  
Energy Savings  
Performance Contracting  
Program (ESPC)



Cut the Energy Use  
Indicator (EUI) of  
Capitol Campus by  
over 40%



New Capitol  
Campus Child Care  
facility is Net Zero

# DES COMBATS CLIMATE CHANGE

## **DES Facility Professional Services and Capitol Campus**



Installed over  
300kW of Solar  
Photovoltaic  
arrays on Capitol  
Campus



Capitol Campus  
electricity is  
100% wind  
power



Nearly met  
2030 target for  
GHG  
reductions in  
2020

# DES COMBATS CLIMATE CHANGE

- **DES Fleet Operations**

- Across the Capitol Campus, DES has installed:
  - (48) level 2 electric vehicle chargers at agency zoned stalls.
  - (16) level 2 electric vehicle chargers for employee workplace charging.
  - (2) level 3 DC Fast Chargers for public use at the NRB Visitor lot.
- Currently 3% of the fleet is electric – 124 electric vehicles out of 5,067
- DES continually evaluates the effectiveness of the Motor Vehicles (05916) and Electric Vehicle Supply Equipment (EVSE, 04016) master contracts as well as the new vehicle purchase request forms to ensure agencies are prioritizing battery electric (BEV) vehicles

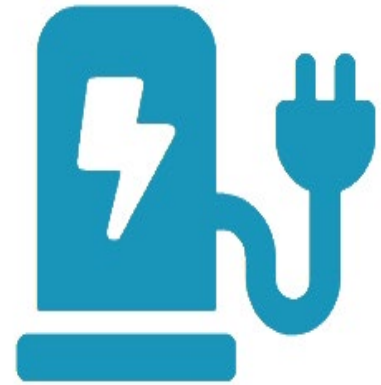
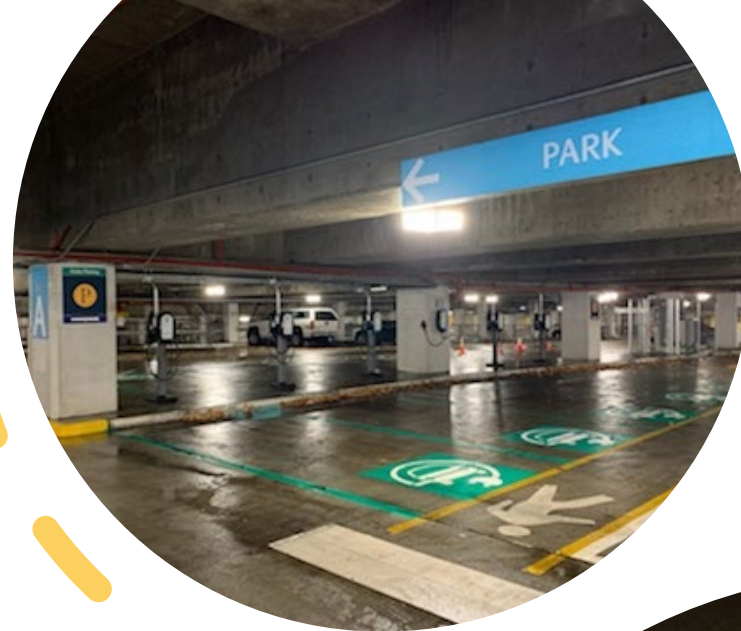

# DES COMBATS CLIMATE CHANGE

- **Executive Order 20-01: State Energy & Environment Performance (SEEP)**
  - Completed **14** electric vehicle supply equipment projects
  - Installed **90** level II charging stations
  - Located at leased and owned facilities statewide
  - Total of **\$920K** spent on site installations

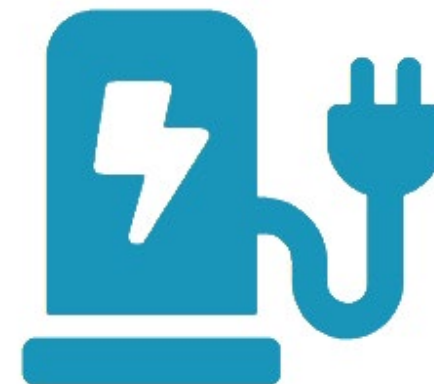
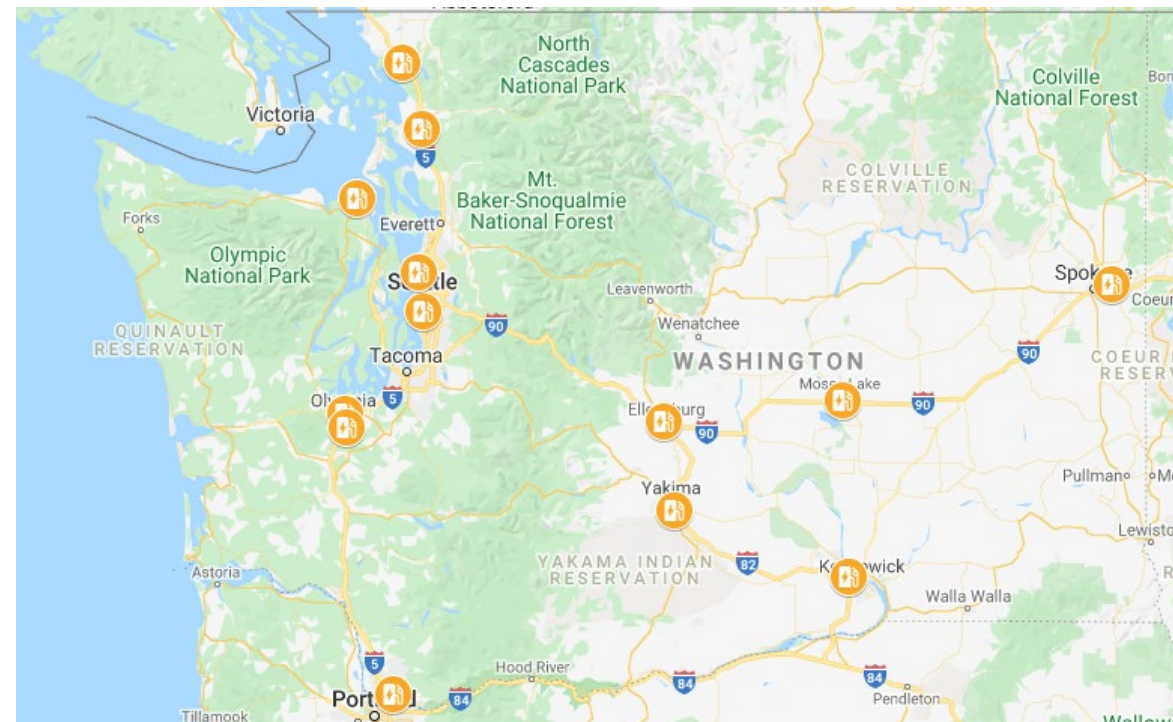

# DES COMBATS CLIMATE CHANGE

## **Reducing Toxics and Single-Use Plastics through Environmentally Preferred Purchasing (EPP)**

- Growing the WA State EPP Program
- Developing 2021-2022 EPP Action Plan
- Creating First Annual “Greening Washington” Purchasing Report
- Developing new DES-hosted state EPP Website
- Creating COVID Safe Return to Work and Green Cleaning Guidance
- Developing new State EPP Manual with proposed green standards for procurement and purchasing professionals to utilize

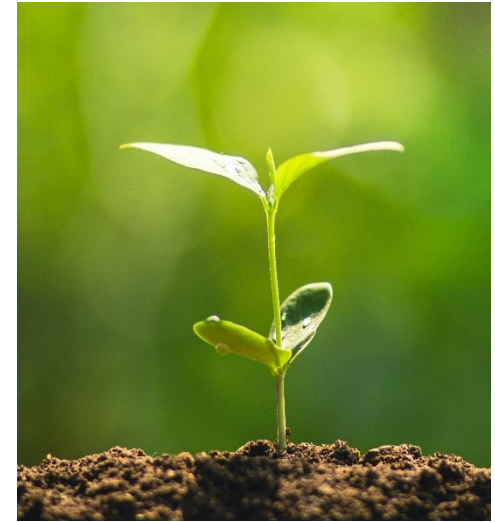

# ALASKA STREET BUILDING

11 18 2021

Ron Major, Resource Conservation Manager  
Facility Professional Services

# ALASKA STREET BUILDING



- 1960's era headquarters and training facility for the WA, Department of Services for the Blind.
- Located in the Columbia City neighborhood of Seattle.

# ALASKA STREET BUILDING

## TOTAL COST OF OWNERSHIP

### Option # 1

NG Boiler & Chiller	Cost
Total Project Cost	\$990,000
Total Cost of Ownership (at 30 years)	\$5,003,668
Fund Balance Spend Down	\$562,000
Increase in Tenant Rent beginning July 2021	\$15.57

### Option # 2

Heat Pump, Windows, Lighting	Cost
Total Project Cost	\$2,723,000
Total Cost of Ownership (at 30 years)	\$3,929,970
Fund Balance Spend Down	\$430,000
Increase in Tenant Rent beginning July 2021	\$12.14

# ALASKA STREET BUILDING ESPC PROJECT



- Installed new energy efficient windows and added wall insulation.
- Replaced existing natural gas boiler & air cooled chiller with a high efficiency air cooled heat pump system.
- Replaced all hydronic piping and installed new high performance terminal units.
- New LED lighting throughout...including installation of new parking lot lighting for increased safety of staff.
- Replaced existing electrical switch gear, correcting a life safety issue.



# ALASKA STREET BUILDING RESULTS



Reduced the Energy  
Use Indicator (EUI)  
from 81.5 kBtu/sf to  
22.5 kBtu/sf



Cut energy  
costs by 50%



Electrified the  
building, eliminating  
Natural Gas use



Building is now Net Zero  
Carbon (Seattle City Light  
electricity is 98% hydro)

# THANK YOU



Ron.Major@des.wa.gov



360-239-4134



<https://des.wa.gov/>

# Results Washington: Climate Change Project

Phase 1	Phase 2
Initial milestones: <ul style="list-style-type: none"><li>• Identify key stakeholders</li><li>• Select performance measures</li><li>• Project charter and implementation plan</li></ul>	Make emissions reduction recommendations for enterprise and agency decision-making and processes. <ul style="list-style-type: none"><li>• 2021 State Energy Strategy</li><li>• Equity and justice considerations</li></ul>
Explore ways to include equity and environmental justice in state's emissions reduction work.	Communications plan to share reduction recommendations with stakeholders.
Update data collection and guidance for 2021 reporting year.	Collect 2021 data on agency electricity and fuel use. Leverage data and agency strategies to make progress towards GHG limits.
Collect 2020 data on agency electricity and fuel use. Leverage this data to make progress towards emissions limits.	Solicit feedback from Results Washington team and stakeholder groups to support recommendations to the Legislature in 2022.

# We strengthen communities

---

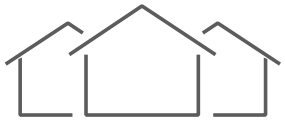

**HOUSING  
HOMELESSNESS**



**INFRASTRUCTURE**



**BUSINESS  
ASSISTANCE**



**ENERGY**

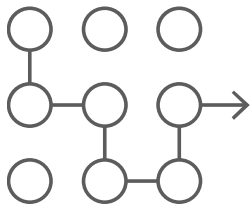

**PLANNING**

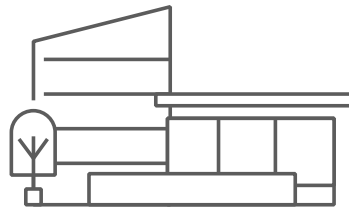

**COMMUNITY FACILITIES**



**CRIME VICTIMS &  
PUBLIC SAFETY**



**COMMUNITY  
SERVICES**

# Commerce and Results Washington

---

## Commerce participation in 2021 Results Washington projects:

- Early learning
- Career Connect
- Economic recovery – post-COVID
- Climate change
- Reduce homelessness
- Behavioral health – community option

# Healthy Environment for All Act

---

- In 2021, lawmakers passed the Healthy Environment for All Act.
- The HEAL Act advances recommendations made by the Environmental Justice Task Force.
- The law's intent is to:
  - Remedy the effects of policies and practices that led to environmental health disparities in communities. Improve the health of all people in Washington.
  - Prevent and address environmental health disparities in the administration of ongoing and new environmental programs, including allocation of funds.
  - Reduce exposure to environmental hazards in Indian Country.
  - Track and measure the accomplishments of state agency environmental justice implementation.

# HEAL Act background

---

People of color, indigenous individuals and communities, and low-income people are disproportionately harmed by environmental health hazards. Centering their needs is essential to advancing Commerce's mission of strengthening communities.

- **State agency coordination and actions:**
  - Adopt a community engagement plan centering environmental justice.
  - Incorporate environmental justice into agency strategic plans.
  - Incorporate environmental justice into Tribal consultation frameworks.
  - Prioritize environmental justice in budget and funding decisions.
  - Conduct environmental justice assessments on our programs and policies.

# SEEP equity and justice checklist

---

## Goals:

- Understand who benefits and who is affected by the project.
- Ensure the project doesn't have adverse impacts or contribute to environmental and health disparities.
- Where possible, create benefits for communities that reduce environmental and health burdens.

## Project considerations:

- **Location.**
- **Lifecycle impacts.** Don't limit your analysis to the final product; consider the base materials, parts and components over time.
- **Human health and environmental impacts** of the project.
- **Greenhouse gas emissions,** including during development and over the project's lifecycle.
- **Hiring local resources and contractors** to do this work.

# Leading by example to fight climate change

---





Washington State  
Department of  
**Commerce**

[www.commerce.wa.gov](http://www.commerce.wa.gov)



# Thank you!

Kendrick Stewart

DEPUTY DIRECTOR

[kendrick.stewart@commerce.wa.gov](mailto:kendrick.stewart@commerce.wa.gov)

A large, faint, light blue watermark of the Seal of the State of Washington is visible in the background. It features a portrait of George Washington, the text "THE STATE OF WASHINGTON", and the year "1889".

# Governor Q&A

# Closing Remarks



THANK YOU FOR ATTENDING TODAY!

PLEASE TAKE A MOMENT TO  
COMPLETE OUR BRIEF SURVEY

YOU CAN VIEW THE RECORDING OF  
TODAY'S MEETING AT:

[HTTPS://RESULTS.WA.GOV/MEASURING-  
PROGRESS/PUBLIC-PERFORMANCE-  
REVIEWS](https://results.wa.gov/measuring-progress/public-performance-reviews)